



GIT-TOPLine12 Track & Magnet Profile

Type: _____
 Project: _____
 Catalog#: _____

Main Features

- Fantastic for accent lighting
- Comes with end caps which will attach onto the ends of the profile
- Optional recessed, suspension, track & magnet mount available
- Works with Green Image Tech's Strip lights
- Recommended use with GS-50WFX1

Technical Information



GIT-TOPLine12

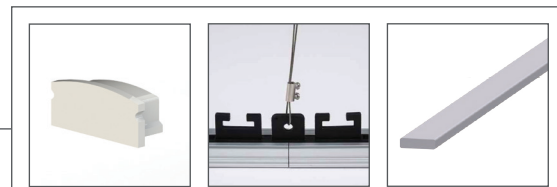
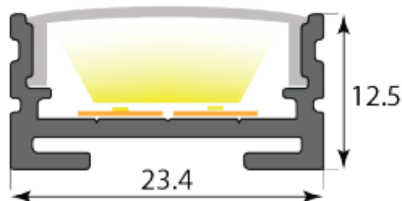

L: End cap, C: Mount Options, R: Connector Options

Specification Features

Model	GIT-TOPLine12		
Length	2500mm	Cover Options	Clear, Milky, or Frosted
Dimensions (mm)	23.4 x 12.5mm		
Material	Anodized Aluminum	Max LED Strip	20mm



GIT-TOPLine12 Track & Magnet Profile

Order Form

Series	Length	Model	Cover Options	Mount Options	Connector Options
<input checked="" type="checkbox"/> TOPLine	<input type="checkbox"/> 2500 (2.5m)	<input type="checkbox"/> 12	<input type="checkbox"/> Clear <input type="checkbox"/> Milky <input type="checkbox"/> Frosted	<input type="checkbox"/> Recessed <input type="checkbox"/> Suspension <input type="checkbox"/> Track <input type="checkbox"/> Magnet	<input type="checkbox"/> Standard <input type="checkbox"/> Mini <input type="checkbox"/> T-shape <input type="checkbox"/> 90°

Accessories

Mount Options

The INLine and TOPLine series also has the option of track mounting or magnet mounting (not pictured below).

Suspension

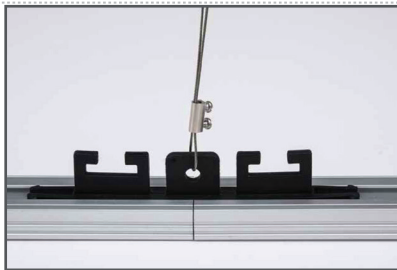
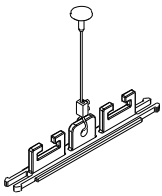

Recessed

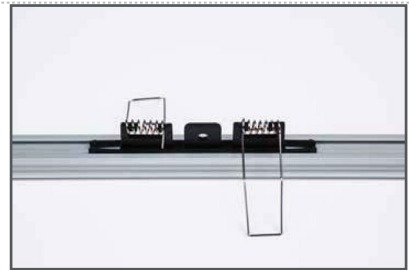
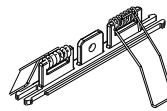

Connector Options

The INLine and TOPLine series has the option of manipulating the length and shape of the profile via the usage of connectors

Standard

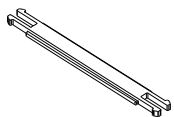

Mini

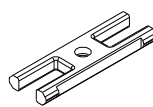

90°

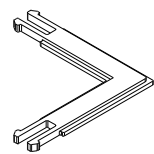

T-Shape

